

# OPEN RANGE

2023 FIFTH WHEELS



45.6815° N, 111.0320° W  
Bozeman, Montana

*Built to Run*





2023 Open Range 373RBS

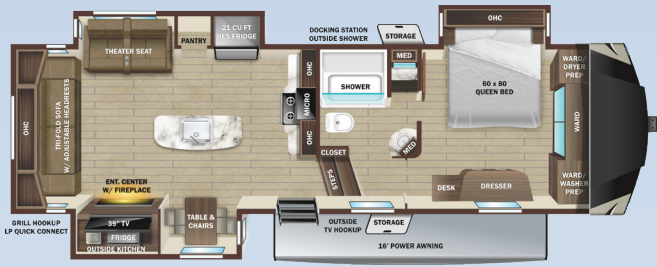

**284RLS**



**371MBH** OPTIONS B & C

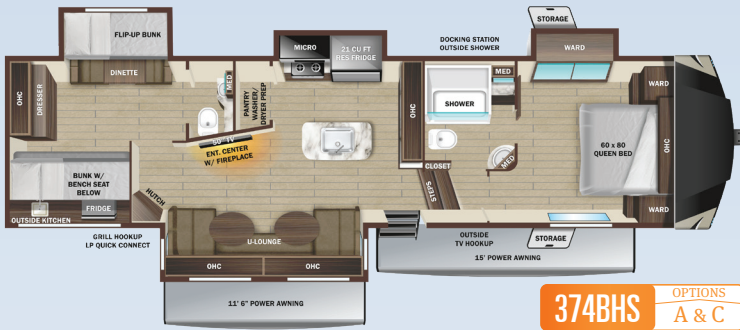

**374BHS** OPTIONS A & C



**373RBS** OPTION C

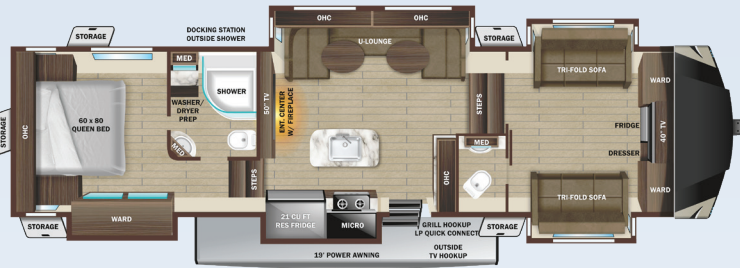

**376FBH** OPTION A



**379FBS** OPTIONS B & C



**395BHS** OPTIONS A & C

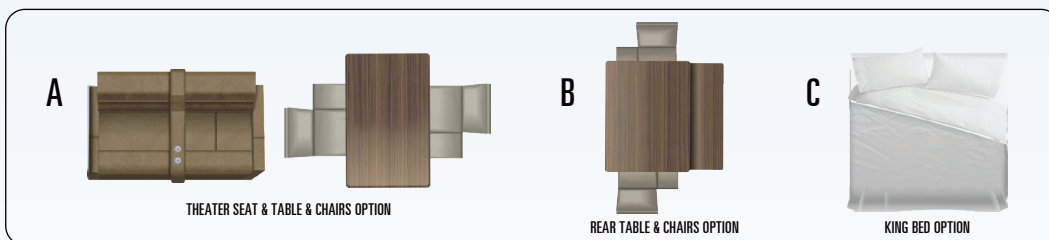

Optional 18 cu. ft RV gas/electric refrigerator (available on all floorplans shown)

## STANDARD INTERIOR EQUIPMENT

- » 21 cu. ft. residential refrigerator
- » 60" x 80" residential queen bed with storage below
- » 75 lb. ball bearing drawer guides
- » Cable and satellite prep
- » Flush floor slides with residential vinyl flooring
- » Glass shower door
- » Hardwood ceiling soffit
- » Hardwood slideout fascia
- » Hardwood valances
- » Large freestanding oven and 4-burner range
- » LED interior lighting
- » One-piece fiberglass shower
- » Raised panel hardwood cabinet doors
- » Residential convection microwave
- » Roller day and night shades
- » Table and chairs
- » Theater seating with heat and massage
- » USB ports in master bedroom
- » VoiceLINK™ voice command system- controls lighting, heating and cooling along with TravelLINK
- » Wall controlled power vent (kitchen/living room area)
- » Washer/dryer prep

## STANDARD EXTERIOR EQUIPMENT

- » 100" wide body frame
- » 2" receiver hitch
- » 3-20 lb. LP bottles
- » 50 amp service
- » ACCU-SLIDE™ slide system (42" deep 4-corner compression)
- » Battery disconnect switch
- » Brass hanger bushings with wet bolts
- » Equa-Flex® axle suspension
- » Exterior grill/griddle quick connect port
- » Frameless windows
- » Laminated block foam floor

- » LevelLoc™ - 4 or 6 point automatic leveling with JT's Strong Arms®
- » Marine grade exterior speakers (2)
- » PVC roofing membrane (limited lifetime warranty)
- » Rear roof access ladder
- » Self-adjusting electric brakes
- » Spare tire
- » TuffShell™ -vacuum bonded laminated construction, reinforced with heavy-duty fiberglass and welded aluminum frames

## EXECUTIVE PACKAGE (MANDATORY)

- » 13,500 BTU A/C with quiet residential return air-bedroom
- » 15,000 BTU A/C with quiet residential return air-main living
- » Cutting board and sink strainer
- » Dome style digital TV antenna with Wi-Fi prep
- » Interior convenience center light
- » JBL® Aura Cube stereo with Bluetooth® and miZONE™ technology
- » JBL® Premium indoor and outdoor mutlizon speakers
- » Keyed-Alike® entry and baggage doors
- » LED HDTV
- » Motion sensor lighting in bedroom and hallway
- » Painted fiberglass front cap with LED lighting
- » Power awning with LED lighting
- » Quick recovery gas/electric water heater
- » Quick release fresh water drain
- » Residential high-rise faucet with pull-down sprayer
- » Single basin stainless steel under-mount kitchen sink
- » Solar prep
- » Solid swing-down entry steps
- » Solid-surface kitchen countertops
- » Stainless steel appliances
- » TravelLINK® - Smart RV system that allows for Bluetooth® control of awnings, lighting, slideouts, heating, cooling and more
- » USB/12V charging port

## FOUR SEASON PACKAGE (MANDATORY)

- » Double insulated baggage doors
- » Ducted heat to underbelly with cold air return
- » Enclosed cable operated gate valves
- » Enclosed exterior docking station with black tank flush
- » Heated and enclosed underbelly
- » High performance furnace
- » R-38 reflective foil insulation in ceiling and underbelly
- » R-9 block foam insulation in sidewalls

## OPTIONS

- » Xtend Solar II Package (2-200 watt solar panels with 30 amp solar controller and 1800 watt inverter)
- » 18 cu. ft. RV gas/electric refrigerator
- » BBQ grill
- » Curt AirRide pinbox
- » Dual pane windows
- » Folding dinette chairs (2)
- » Generator prep - LP
- » Heat pump (main A/C)
- » King bed (N/A 284RLS, 376FBH)
- » Main bedroom TV - 32"
- » Observation camera
- » Slideout awning covers
- » Theater seats and table ipo standard u-lounge sofa (374BHS, 376FBH)
- » Wall controlled power vent - bathroom
- » Wall controlled power vent - living room (376FBH)
- » Wi-Fi router

## SPECIFICATIONS

May Include Estimated Values

	284RLS	374BHS	376FBH	371MBH	373RBS	379FBS	395BHS
Unloaded Vehicle Weight (lbs.)	10,170	12,595	12,240	12,665	13,000	12,495	13,260
Dry Hitch Weight (lbs.)	1,780	2,315	2,515	2,350	2,495	2,245	2,575
Gross Vehicle Weight Rating (GVWR)	12,500	15,500	15,000	15,500	15,500	15,500	16,250
Cargo (Gross)	2,330	2,905	2,760	2,940	2,500	3,005	2,990
Exterior Length (Pin to Rear)	32' 9"	39' 7"	40' 8"	41' 0"	41' 6"	42' 0"	42' 6"
Exterior Length (Overall)	34' 3"	41' 1"	42' 3"	42' 5"	43' 0"	43' 1"	43' 7"
Exterior Height	12' 10"	13' 2"	13' 2"	13' 1"	13' 1"	13' 1"	13' 0"
Exterior Width	8' 4"	8' 4"	8' 4"	8' 4"	8' 4"	8' 4"	8' 4"
Exterior Width (Slides Out)	14' 9"	14' 11"	13' 9"	13' 11"	14' 9"	14' 9"	13' 8"
Interior Height (Upper Deck)	6' 6"	6' 5"	6' 4"	6' 4"	6' 6"	6' 4"	6' 4"
Interior Height (Lower Deck)	8' 2"	8' 2"	8' 2"	8' 2"	8' 2"	8' 2"	8' 2"
Fresh Water Capacity (Gal.)*	85	85	85	85	85	85	85
Gray Waste Water Capacity (Gal.)	97	132	82	80	80	114	80
Black Waste Water Capacity (Gal.)	40	80	82	40	80	80	80
LP Capacity (lbs.)	60	60	60	60	60	60	60
Tire Size	16"	16"	16"	16"	16"	16"	16"
Awning Size	16'	11' 6", 15'	19'	16'	16', 14'	20'	13', 16'

\*Includes Water Heater

TO LEARN MORE VISIT  
[openrangerv.com](http://openrangerv.com)



Highland Ridge RV – Part of the Jayco Family of Companies



## LOCAL DEALER INFO



Due to continual research and advances, manufacturer reserves the right to change specifications, design, price, and equipment without notice, and assumes no responsibility for any error in the literature. Some items shown are not included as standard or optional equipment. 2032620.2023